

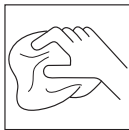

Light Vacuuming or  
dusting



No Solvents, chemicals,  
or abrasives



For child and pet safety  
please secure cords and  
chains with supplied  
tension device.

Thank you for your purchase. For any questions or comments please  
contact Elite customer service at the number listed below.

**ELITE**  
WINDOW FASHIONS™

**ELITE**  
WINDOW FASHIONS™

## Z - RS Fascia

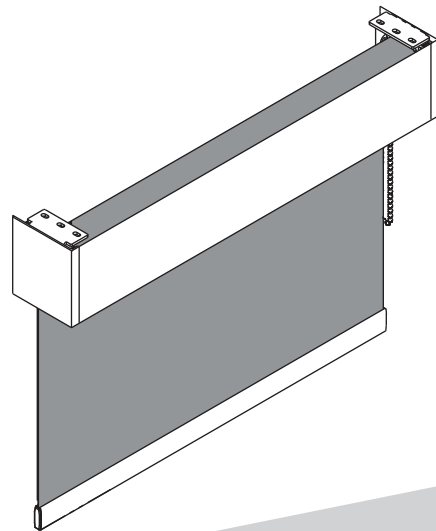

## Shade Installation / Montage

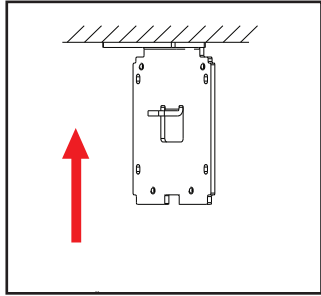

fig. 1

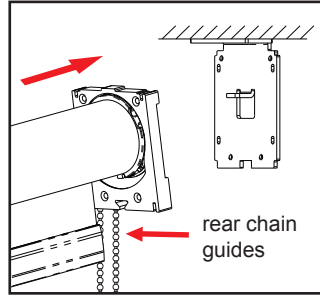

fig. 2

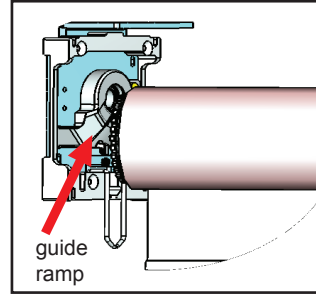

fig. 3

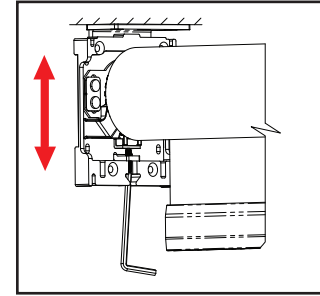

fig. 4

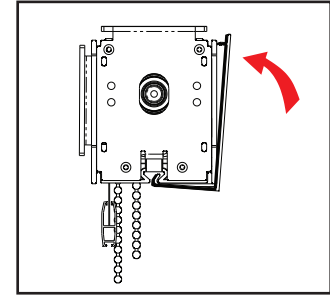

fig. 5

1. Mount installation brackets to ceiling or wall (fig. 1).
2. Install clutch on bracket (fig. 2) and pass chain through **rear chain guides**. If using side channels, chain must pass through **front chain guides**.
3. Compress the idler end pin and slide into the bearing hole using the guide ramp (fig 3).
4. Screw clutch into bracket using at least 2 screws. 1 screw **must** be installed between the chains. Shade level can be adjusted if necessary by using the supplied allen key (located in the idler bracket, see fig. 4).
5. Install the fascia by hooking into bottom of brackets, then snap top portion into place (fig. 5). Install plastic endcaps.

**Removal:** Pull top of fascia to remove using red hook tool (supplied). Unscrew clutch, then use plastic wrench (supplied) to retract idle end pin, slide shade out of brackets.