

### REQUIRED TOOLS FOR INSTALLATION

OPEN ROLL, MODELS Z-125 | Z-150

#### Tape Measure

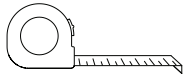

#### Level

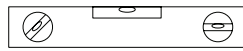

#### Power Drill / Screwdriver

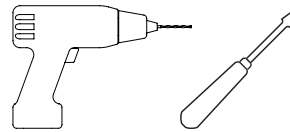

#### Pencil

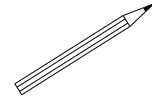

### COMES WITH YOUR ORDER

#### Valance

If Ordered

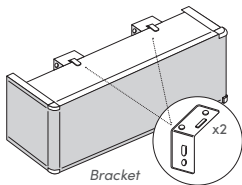

\*Note: Valance Returns are optional

#### Shade Brackets

SpringDrive | WandControl | E-Touch

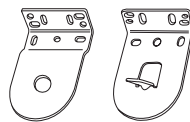

Idler-end Bracket  
Control-end Bracket

#### Shade Brackets

FreeMotion

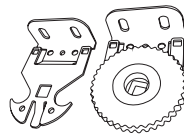

Idler-end Bracket  
Control-end Bracket

#### Screws



#### Roller Shade

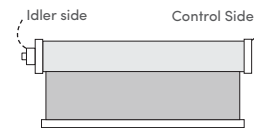

#### End Caps

If Ordered

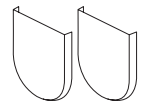

### ROLLER SHADE INSTALLATION

#### STEP 1 - VALANCE INSTALLATION (If Ordered)

#### NOTES

- Valance must be installed as a first step before the Roller Shade. If you didn't order a Valance proceed to Step 2.

**A** - For **INSIDE** mount, divide valance width into thirds and mark 2 screw holes on the underside of the valance. Drill through cover to secure the valance in place.

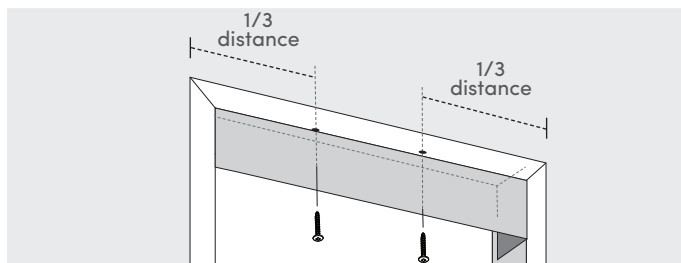

**B** - For **OUTSIDE** mount, **mark the location** of the shade mounting brackets with a pencil (see step 2), and measure 1/2" from the top of the bracket to note the location of the Valance bracket. Valance brackets should be installed 5"-8" from each end of the valance. Additional bracket(s) may be necessary and should be evenly spaced between the two ends brackets if required.

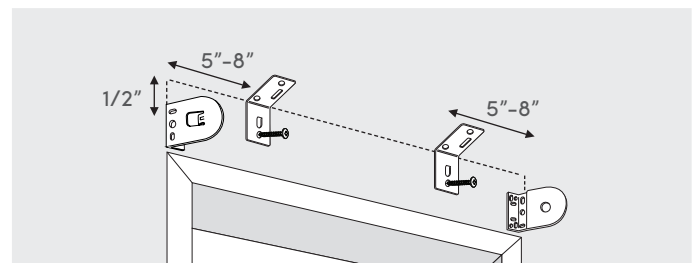

### STEP 2 - BRACKET INSTALLATION

#### NOTES

- Before fully installing your brackets, note the difference between the control and idler brackets.
- In order to ensure the shade does not fall out of the brackets, it is critical that the idler pin is **securely compressed by at least 1/4"** upon installation. If pin is too loose, shade may fall out of brackets. If pin is compressed too tightly, shade may not operate properly. To prevent this, please ensure brackets are installed the exact width ordered.
- End caps are not required when installing a valance or for inside mount installation.

Idler pin must compress at least 1/4" to ensure shade is properly secured in the brackets.

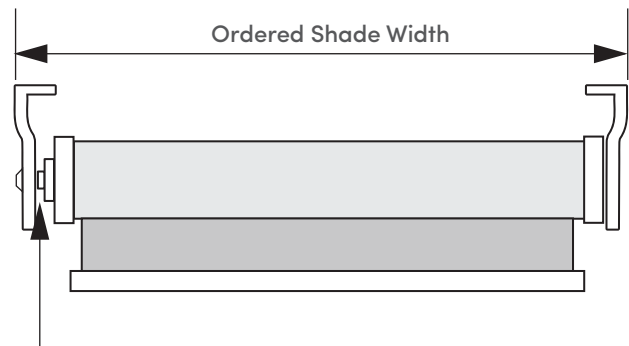

#### BRACKET INSTALLATION

Brackets can be positioned for inside mount or outside mount installations. Install the brackets according to L or R side controls.

##### A Outside Position

##### B Inside Position

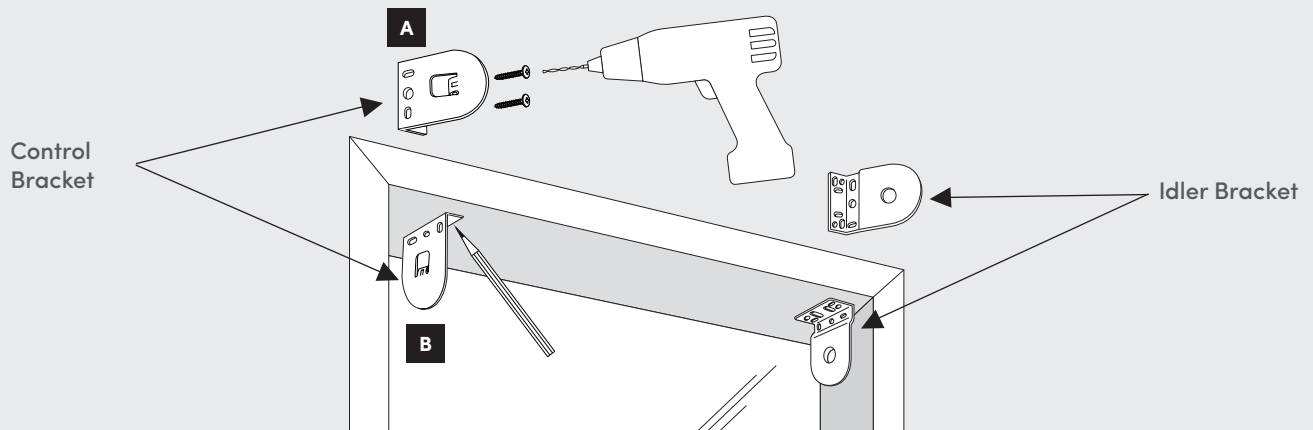

**Inside / Outside Mount:** Using a steel measuring tape, measure the distance from the **outside edge** of each bracket according to the ordered shade width. Mark the screw location on the mounting surface with a pencil ensuring these are leveled, snap end caps onto brackets (if ordered).

Fasten brackets according to Left or Right side controls in the marked locations using the screws provided (drywall plugs, if required, can be purchased from a local hardware store). Ensure brackets are secure, leveled, parallel and facing towards each other.

### NOTES

- Ensure fabric rolls in the direction you specified (regular or reverse roll)
- Your control side depends on what you specified in your order

#### Regular Roll

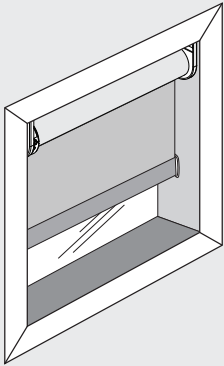

Fabric rolls off the back of the tube, closest to the window

#### Reverse Roll

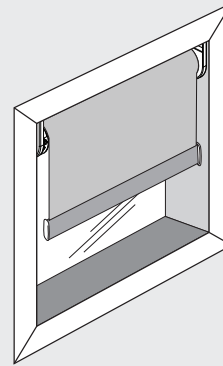

Fabric rolls off the front of the tube, into the room.

### STEP 3 - SHADE INSTALLATION

(SPRINGDRIVE | WANDCONTROL | E-TOUCH | CHAINGUARD)

**A** - Insert the control-end bracket lip into the control side.

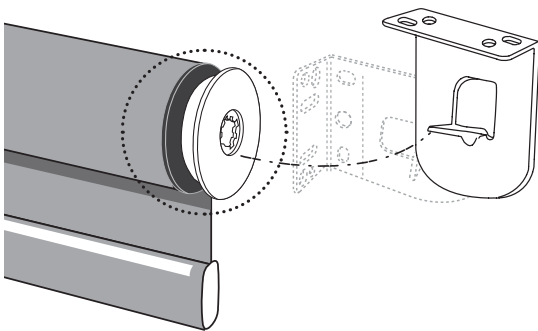

**B** - The idler end has a spring-loaded pin that allows it to compress in/out. Compress the pin and insert the idler-end into the idler-end bracket.

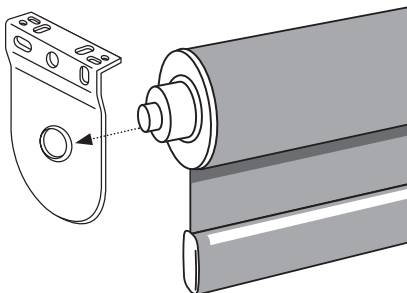

### STEP 3 - SHADE INSTALLATION

(FREEMOTION)

**A** - Partially install the control-end into the control bracket. Remove pin from control-end when secured.

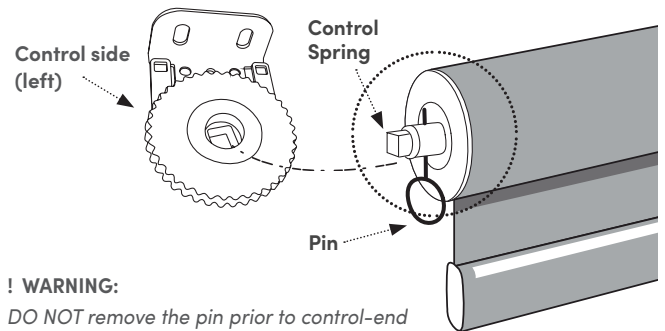

**! WARNING:**  
DO NOT remove the pin prior to control-end installation. Removing the pin will release spring tension making the shade inoperable.

**B** - Insert the idler-end into the idler-end bracket. Ensure the control spring is compressed a minimum of 1/2" for proper operation.

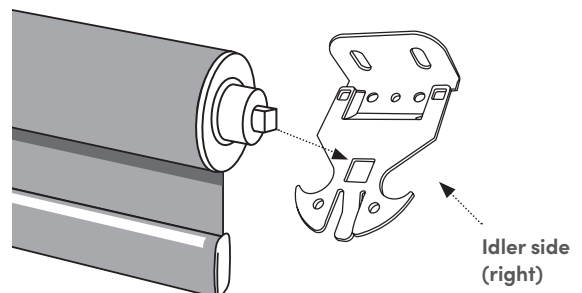

### STEP 4 - P-CLIP INSTALLATION (CHAINGUARD ONLY)

#### CHILD/SAFETY CHAIN TENSIONER INSTALLATION

This device **MUST** be properly installed in accordance with Health Canada regulations on corded window covering products. Fasten P-Clip against the window frame or wall. Position the P-Clip so it does not interfere with the travel of the shade. Chain should be tight, but not under stress when adhered to the P-Clip. Fasten the P-Clip using screws provided. **Do not twist the chain.**

**To operate the chain** slide ChainGuard up, exposing the bottom of the chain. Use the exposed chain to raise or lower your shade accordingly. Release the ChainGuard to conceal the chain.

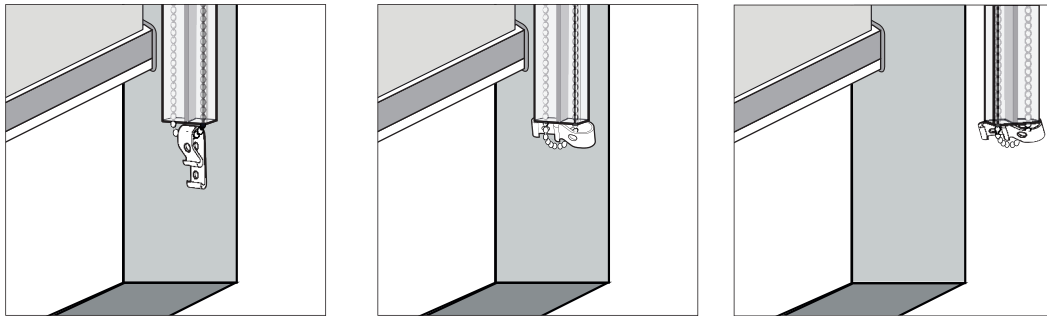

### STEP 5 - TENSION ADJUSTMENT (FREEMOTION ONLY)

#### Tension Adjustment

\*Tension can be adjusted by rotating the dial located on left side of shade (right side for reverse roll).

- If shade is raising on its own, loosen the tension by turning the dial clockwise.
- If shade is lowering on its own, increase tension by turning the dial counter-clockwise.



**FABRIC ADJUSTMENT**

If telescoping occurs, roll your shade down a few inches pass the window sill and place tape on the fabric as close to the top as possible on the side you want to bring down. Repeat this process as many times as necessary by layering the tape.

**MAINTENANCE & CARE**

Fabrics can be periodically dusted using a soft cloth, feather duster, or vacuum cleaner with brush attachment. If staining does occur, most fabrics can be cleaned using a soft cloth with water or a mild soap detergent. Any detergent or cleaning product should be tested on a small area prior to cleaning the fabric. Do NOT use abrasives or harsh cleansers as they can damage the fabric. Dab with a cloth or towel to prevent water spots and roll shade down to the window sill to allow the fabric to air-dry.

**⚠️ WARNING**

**STRANGULATION HAZARD:** Young children can be strangled by cords. Immediately remove this product if a cord longer than 22cm or a loop exceeding 44cm around becomes accessible.

**⚠️ MISE EN GARDE**

**RISQUE D'ÉTRANGLEMENT:** Les enfants en bas âge peuvent s'étrangler avec des cordes. Enlevez immédiatement ce produit si une corde mesurant plus de 22 cm devient accessible ou si le contour d'une boucle de plus de 44 cm devient accessible.



For french installation instructions, scan the QR code.